

CONTACT: JONATHAN POPOWICH
PHONE: 403 923 4700
EMAIL: JONATHAN@POPOWICHREALESTATE.COM

MEASUREMENT SUMMARY AND ROOM DIMENSIONS
ADDRESS: 41 NEW BRIGHTON HEIGHTS SE
CALGARY, ALBERTA
PROPERTY TYPE: DETACHED

MEASURED ON: SEPTEMBER 7, 2024

BEDROOMS: 1/2

BATHROOMS: 3

MAIN INFO

Main Level Above Grade Area (RMS)	783.0sq.ft.	72.7sq.m.
Upper Level Above Grade Area (RMS)	291.0sq.ft.	27.0sq.m.
Total RMS	1074.0sq.ft.	99.8sq.m.
Finished Lower Level Below Grade	208.7sq.ft.	19.4sq.m.
Finished Basement Level Below Grade	557.5sq.ft.	51.7sq.m.
Unfinished Below Grade	97.7sq.ft.	9.0sq.m.
Total Below Grade	864.0sq.ft.	80.2sq.m.
Exterior Wall Thickness	6.5 inches	Total Billable Area: 1938.0sq.ft./ 180.0sq.m.

MAIN LEVEL (9' CEILING)

Kitchen	12'8"x11'5"
Pantry	5'5"x3'10"
Living Room	13'0"x13'0"
Dining Room	10'8"x7'5"
Foyer	5'0"x4'0"
Office	11'11"x9'11"
4pc Bath	7'11"x5'6"
Mud Room	6'2"x4'5"

UPPER LEVEL (9' CEILING)

Primary Bedroom	13'8"x11'9"
3pc Ensuite Bath	8'0"x5'0"

LOWER LEVEL (8' CEILING)

Kitchen	16'0"x13'0"
---------	-------------

BASEMENT LEVEL (8' CEILING)

Rec Room	18'3"x12'3"
Bar Area	7'6"x6'9"
Second Bedroom	11'0"x10'7"
4pc Bath	8'5"x4'11"
Utility + Storage Room	11'0"x5'0"
Laundry Room	7'4"x7'4"
Storage Space	6'10"x6'3"

AUXILIARY AREAS

Garage	24'0"x24'0"
Front Porch	7'0"x7'0"

403-585-3839



CALGARY PHOTOS
WWW.CALGARYPHOTOS.CA

INFO@CALGARYPHOTOS.CA

All Measurements Certified, Guaranteed and Insured through Calgary Photos.
Areas are calculated using RECA RMS measurement standards and are covered under E&O through Calgary Photos.
Calgary Photos retains copyright and ownership of all measurements, payment by the client permits use for listing purposes.
This report is non-transferable and may not be re-sold.

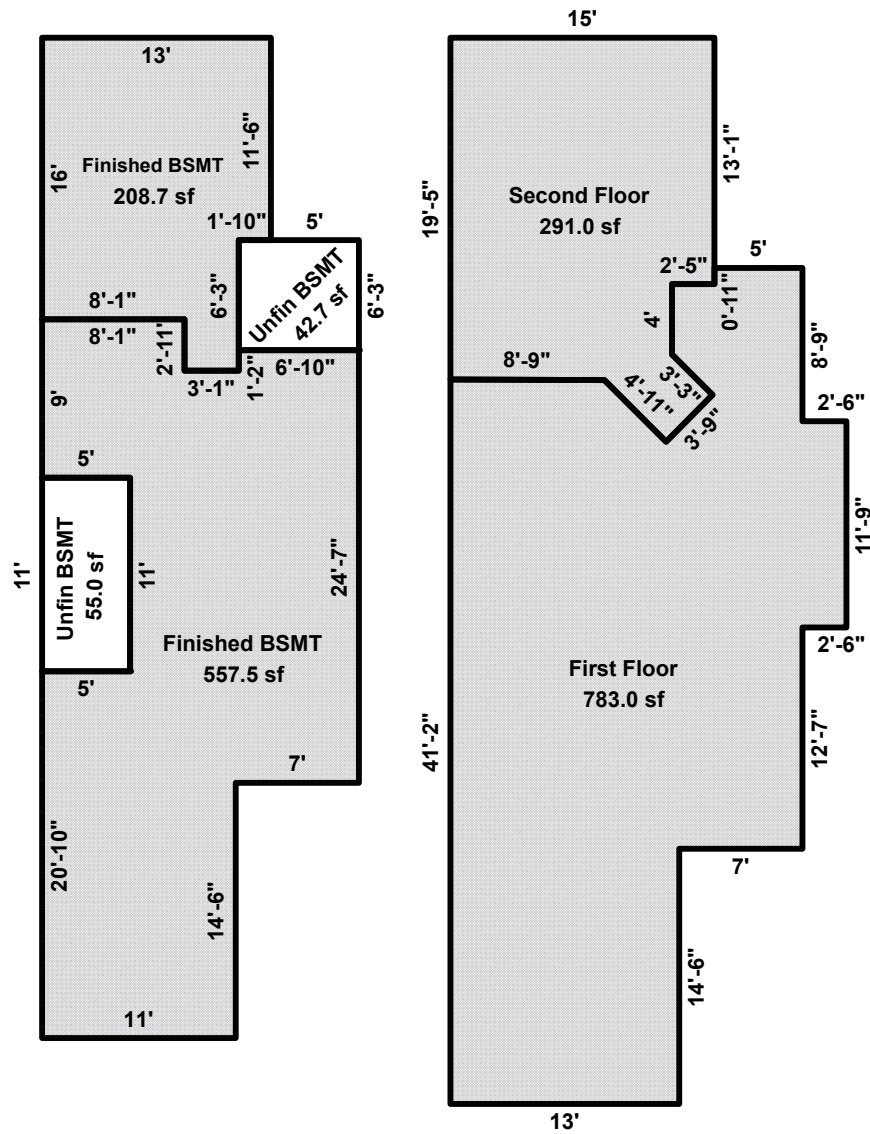

Sketch by Apex Sketch

Code	Description	Factor	Net Size	Perimeter	Net Totals
GLA1	First Floor	1.0	783.0	146.7	783.0
GLA2	Second Floor	1.0	291.0	75.5	291.0
BSMT	Unfin BSMT	1.0	42.7	26.2	
	Unfin BSMT	1.0	55.0	32.0	
	Finished BSMT	1.0	208.7	63.8	
	Finished BSMT	1.0	557.5	130.0	864.0

Net LIVABLE

(rounded)

1,074